

# Tiflex Hose GL-E type

## Features

- Grounding can be done by utilizing the grounding wire put through the hose rigid part by which worries caused by the build-up of static electricity are overcome.
- Low in air flow resistance making it possible to improve the conveying capacity.
- Transparent making it possible to confirm the contents.
- Cutting of hose and exposure of grounding wire are easy.

## Applications

- Dust collection of wood working machine and pneumatic conveying of powders.
- Indoor piping of clean room where static electricity is undesirable.

Hose



Structure (Cross-Section View)

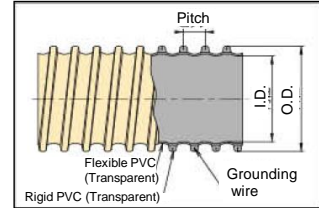

Sizes and properties (GLE-□)

Nominal Dia. (φ)	I.D. (mm)	O.D. (mm)	Pitch (mm)	Working Pressure (20°C) MPa or less/ [kgf/cm <sup>2</sup> or less]	Allowable Reduced Pressure (20°C) KPa or less/ [mmHg or less]	Bending Radius (mm or more)	Ref. Weight (g/m)	Std. Length (m)
38	38.1±1.0	44.5	9.0	0.06 [0.6]	-66.5 [-500]	35	340	20
50	50.8 <sup>+1.5</sup> <sub>-1.0</sub>	59.9	12.0	0.05 [0.5]	-66.5 [-500]	50	520	
65	63.5 <sup>+1.5</sup> <sub>-1.0</sub>	72.6	12.0	0.04 [0.4]	-66.5 [-500]	60	630	
75	76.2±1.5	84.5	14.5	0.04 [0.4]	-33.0 [-250]	75	640	
(90)	89.0±1.5	98.6	14.5	0.03 [0.3]	-33.0 [-250]	85	935	
100	101.6±1.5	112.0	14.5	0.03 [0.3]	-21.0 [-160]	90	950	
125	127.0±1.5	138.2	17.5	0.02 [0.2]	-20.0 [-150]	120	1,120	
150	152.4±1.5	163.8	17.5	0.02 [0.2]	-14.5 [-110]	150	1,430	

( ) is custom-made products.

\* Exclusive cuffs are available.

\* Ground connection is necessary.

\* For antistatic effect, please refer to P31.

## Pulling out and cutting method of grounding wire



1 Apply a knife along the hose rigid part and cut the soft part.



2 Cut a nick into the hose rigid part with a knife.



3 Bend the nicked part of the hose rigid part with hands several times and break this part.

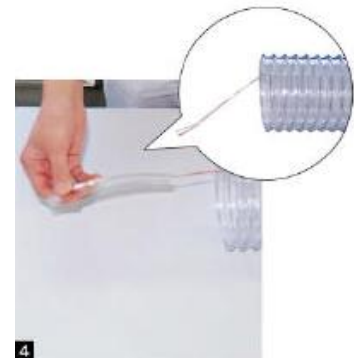

4 Slowly pull off the hose rigid part.

## Setting method of antistatic grounding wire

Connection with Metal Fixture	Connection with Steel Pipe	Connection with Plastic Pipe
<p>In case that exclusive cuff which is fitted the hose connects with a metal fixture.</p>	<p>In case that the cut hose connects with a steel pipe.</p>	<p>Should be grounded directly with grounding wire is coming out from the hose in case of the connection which is difficult to ground.</p>